

## TYPES

- Type **A1**: Cylinder, horizontal
- Type **A2**: Cylinder, vertical
- Type **B1**: Wedge, top
- Type **B2**: Wedge, down
- Type **B3**: Wedge, right
- Type **B4**: Wedge, left

## IDENTIFICATION NO.

- **1**: standard spring load
- **2**: high spring load

## Body

Die-cast zinc alloy **ZD**  
coated in epoxy resin  
black, RAL 9005, matte finish

## Thrust pin

Plastic, smooth **KG**  
Plastic POM, black

Stainless Steel, smooth **NG**  
metal injection molded AISI 630

Stainless Steel, ribbed **NR**  
metal injection molded AISI 630

## Spring

Stainless Steel AISI 301

## Screw

- Steel, zinc nickel coated (Version KG)
- Stainless Steel, A2 (Version NG / NR)

## FEATURES AND APPLICATIONS

Side thrust pins GN 415 have a compact design and offer maximum flexibility for tensioning and holding parts. A variety of thrust pin designs as well as two different spring forces are available.

Depending on the installation situation, the side thrust pins offer a pull-down effect operating within height  $h_2$ . They are fastened by means of holes or slots.

The side thrust pins are installed fully assembled. If necessary, the installation position of the thrust pin slide can be rotated by  $4 \times 90^\circ$  according to the sketch. When installing version KG, the shaped thread in the plastic slider should be reused and the tightening torque limited.



GN 415-A1

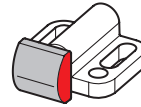

GN 415-A2

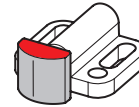

GN 415-B1

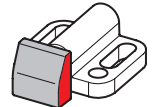

GN 415-B2

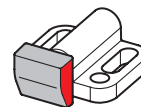

GN 415-B3



GN 415-B4

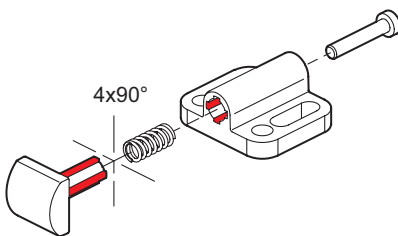
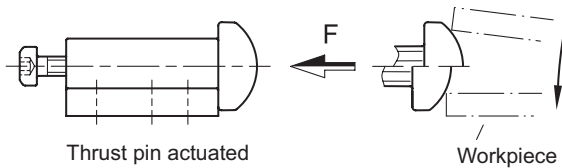
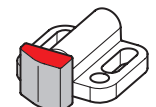

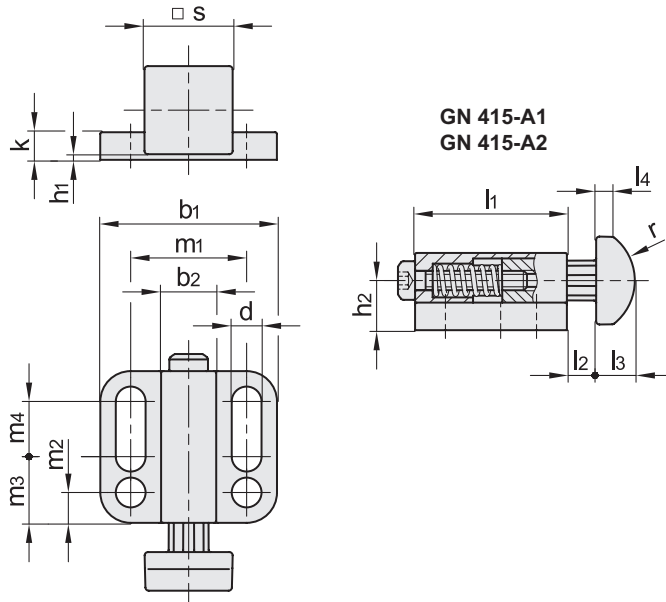

GN 415-A1

INOX STAINLESS STEEL

Code	Description	d	b1	b2	h1 +0.5	h2	k	l1	l2	l3	l4	r	s	m1	m2	m3	m4	[N]*	[N]#	⚙️	
GN.19201	GN 415-ZD-22-A1-KG-1	3.3	22	7	1	6	4	16.5	2.8	4.8	2.4	6.25	10	14	4	8	4.5	8	11	12	
GN.19202	GN 415-ZD-22-A1-KG-2	3.3	22	7	1	6	4	16.5	2.8	4.8	2.4	6.25	10	14	4	8	4.5	11	20	12	
GN.19203	GN 415-ZD-22-A1-NG-1	3.3	22	7	1	6	4	16.5	2.8	4.8	2.4	6.25	10	14	4	8	4.5	8	11	13	
GN.19204	GN 415-ZD-22-A1-NG-2	3.3	22	7	1	6	4	16.5	2.8	4.8	2.4	6.25	10	14	4	8	4.5	11	20	13	
GN.19205	GN 415-ZD-22-A1-NR-1	3.3	22	7	1	6	4	16.5	2.8	4.8	2.4	6.25	10	14	4	8	4.5	8	11	14	
GN.19206	GN 415-ZD-22-A1-NR-2	3.3	22	7	1	6	4	16.5	2.8	4.8	2.4	6.25	10	14	4	8	4.5	11	20	14	
GN.19281	GN 415-ZD-32-A1-KG-1	5.4	32	10	1	9	5	27.5	5	7	3.1	10	16	21	5.5	12	10	8	19	32	
GN.19282	GN 415-ZD-32-A1-KG-2	5.4	32	10	1	9	5	27.5	5	7	3.1	10	16	21	5.5	12	10	19	45	32	
GN.19283	GN 415-ZD-32-A1-NG-1	5.4	32	10	1	9	5	27.5	5	7	3.1	10	16	21	5.5	12	10	8	19	39	
GN.19284	GN 415-ZD-32-A1-NG-2	5.4	32	10	1	9	5	27.5	5	7	3.1	10	16	21	5.5	12	10	19	45	39	
GN.19285	GN 415-ZD-32-A1-NR-1	5.4	32	10	1	9	5	27.5	5	7	3.1	10	16	21	5.5	12	10	8	19	40	
GN.19286	GN 415-ZD-32-A1-NR-2	5.4	32	10	1	9	5	27.5	5	7	3.1	10	16	21	5.5	12	10	19	45	40	
GN.19381	GN 415-ZD-39-A1-KG-1	6.5	39	14.5	1	12	6	35	8.2	10	4.7	13.75	22	27	6.5	15	13.5	17	33	69	
GN.19382	GN 415-ZD-39-A1-KG-2	6.5	39	14.5	1	12	6	35	8.2	10	4.7	13.75	22	27	6.5	15	13.5	27	75	69	
GN.19383	GN 415-ZD-39-A1-NG-1	6.5	39	14.5	1	12	6	35	8.2	10	4.7	13.75	22	27	6.5	15	13.5	17	33	93	
GN.19384	GN 415-ZD-39-A1-NG-2	6.5	39	14.5	1	12	6	35	8.2	10	4.7	13.75	22	27	6.5	15	13.5	27	75	93	
GN.19385	GN 415-ZD-39-A1-NR-1	6.5	39	14.5	1	12	6	35	8.2	10	4.7	13.75	22	27	6.5	15	13.5	17	33	94	
GN.19386	GN 415-ZD-39-A1-NR-2	6.5	39	14.5	1	12	6	35	8.2	10	4.7	13.75	22	27	6.5	15	13.5	27	75	94	

GN 415-A2

INOX STAINLESS STEEL

Code	Description	d	b1	b2	h1 +0.5	h2	k	l1	l2	l3	l4	r	s	m1	m2	m3	m4	[N]*	[N]#	⚙️	
GN.19207	GN 415-ZD-22-A2-KG-1	3.3	22	7	1	6	4	16.5	2.8	4.8	2.4	6.25	10	14	4	8	4.5	8	11	12	
GN.19208	GN 415-ZD-22-A2-KG-2	3.3	22	7	1	6	4	16.5	2.8	4.8	2.4	6.25	10	14	4	8	4.5	11	20	12	
GN.19209	GN 415-ZD-22-A2-NG-1	3.3	22	7	1	6	4	16.5	2.8	4.8	2.4	6.25	10	14	4	8	4.5	8	11	13	
GN.19210	GN 415-ZD-22-A2-NG-2	3.3	22	7	1	6	4	16.5	2.8	4.8	2.4	6.25	10	14	4	8	4.5	11	20	13	
GN.19211	GN 415-ZD-22-A2-NR-1	3.3	22	7	1	6	4	16.5	2.8	4.8	2.4	6.25	10	14	4	8	4.5	8	11	14	
GN.19212	GN 415-ZD-22-A2-NR-2	3.3	22	7	1	6	4	16.5	2.8	4.8	2.4	6.25	10	14	4	8	4.5	11	20	14	
GN.19287	GN 415-ZD-32-A2-KG-1	5.4	32	10	1	9	5	27.5	5	7	3.1	10	16	21	5.5	12	10	8	19	32	
GN.19288	GN 415-ZD-32-A2-KG-2	5.4	32	10	1	9	5	27.5	5	7	3.1	10	16	21	5.5	12	10	19	45	32	
GN.19289	GN 415-ZD-32-A2-NG-1	5.4	32	10	1	9	5	27.5	5	7	3.1	10	16	21	5.5	12	10	8	19	39	
GN.19290	GN 415-ZD-32-A2-NG-2	5.4	32	10	1	9	5	27.5	5	7	3.1	10	16	21	5.5	12	10	19	45	39	
GN.19291	GN 415-ZD-32-A2-NR-1	5.4	32	10	1	9	5	27.5	5	7	3.1	10	16	21	5.5	12	10	8	19	40	
GN.19292	GN 415-ZD-32-A2-NR-2	5.4	32	10	1	9	5	27.5	5	7	3.1	10	16	21	5.5	12	10	19	45	40	
GN.19387	GN 415-ZD-39-A2-KG-1	6.5	39	14.5	1	12	6	35	8.2	10	4.7	13.75	22	27	6.5	15	13.5	17	33	69	
GN.19388	GN 415-ZD-39-A2-KG-2	6.5	39	14.5	1	12	6	35	8.2	10	4.7	13.75	22	27	6.5	15	13.5	27	75	69	
GN.19389	GN 415-ZD-39-A2-NG-1	6.5	39	14.5	1	12	6	35	8.2	10	4.7	13.75	22	27	6.5	15	13.5	17	33	93	
GN.19390	GN 415-ZD-39-A2-NG-2	6.5	39	14.5	1	12	6	35	8.2	10	4.7	13.75	22	27	6.5	15	13.5	27	75	93	
GN.19391	GN 415-ZD-39-A2-NR-1	6.5	39	14.5	1	12	6	35	8.2	10	4.7	13.75	22	27	6.5	15	13.5	17	33	94	
GN.19392	GN 415-ZD-39-A2-NR-2	6.5	39	14.5	1	12	6	35	8.2	10	4.7	13.75	22	27	6.5	15	13.5	27	75	94	

\* Spring preload  
# Spring maximum load

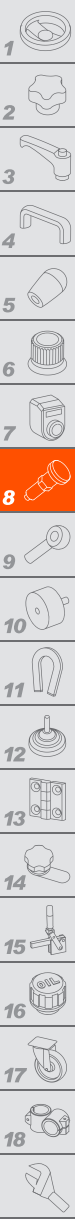

- 1
- 2
- 3
- 4
- 5
- 6
- 7
- 8
- 9
- 10
- 11
- 12
- 13
- 14
- 15
- 16
- 17
- 18

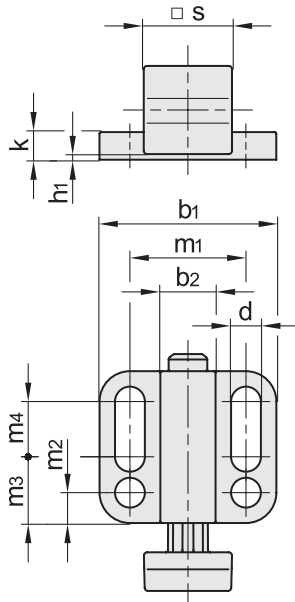

GN 415-B1  
GN 415-B2  
GN 415-B3  
GN 415-B4

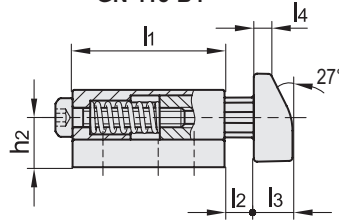

**INOX** STAINLESS STEEL

GN 415-B1

Code	Description	d	b1	b2	h1 +0.5	h2	k	l1	l2	l3	l4	r	s	m1	m2	m3	m4	[N]*	[N]#	△
GN.19213	GN 415-ZD-22-B1-KG-1	3.3	22	7	1	6	4	16.5	2.8	4.8	2.4	6.25	10	14	4	8	4.5	8	11	12
GN.19214	GN 415-ZD-22-B1-KG-2	3.3	22	7	1	6	4	16.5	2.8	4.8	2.4	6.25	10	14	4	8	4.5	11	20	12
GN.19215	GN 415-ZD-22-B1-NG-1	3.3	22	7	1	6	4	16.5	2.8	4.8	2.4	6.25	10	14	4	8	4.5	8	11	13
GN.19216	GN 415-ZD-22-B1-NG-2	3.3	22	7	1	6	4	16.5	2.8	4.8	2.4	6.25	10	14	4	8	4.5	11	20	13
GN.19217	GN 415-ZD-22-B1-NR-1	3.3	22	7	1	6	4	16.5	2.8	4.8	2.4	6.25	10	14	4	8	4.5	8	11	14
GN.19218	GN 415-ZD-22-B1-NR-2	3.3	22	7	1	6	4	16.5	2.8	4.8	2.4	6.25	10	14	4	8	4.5	11	20	14
GN.19293	GN 415-ZD-32-B1-KG-1	5.4	32	10	1	9	5	27.5	5	7	3.1	10	16	21	5.5	12	10	8	19	32
GN.19294	GN 415-ZD-32-B1-KG-2	5.4	32	10	1	9	5	27.5	5	7	3.1	10	16	21	5.5	12	10	19	45	32
GN.19295	GN 415-ZD-32-B1-NG-1	5.4	32	10	1	9	5	27.5	5	7	3.1	10	16	21	5.5	12	10	8	19	39
GN.19296	GN 415-ZD-32-B1-NG-2	5.4	32	10	1	9	5	27.5	5	7	3.1	10	16	21	5.5	12	10	19	45	39
GN.19297	GN 415-ZD-32-B1-NR-1	5.4	32	10	1	9	5	27.5	5	7	3.1	10	16	21	5.5	12	10	8	19	40
GN.19298	GN 415-ZD-32-B1-NR-2	5.4	32	10	1	9	5	27.5	5	7	3.1	10	16	21	5.5	12	10	19	45	40
GN.19393	GN 415-ZD-39-B1-KG-1	6.5	39	14.5	1	12	6	35	8.2	10	4.7	13.75	22	27	6.5	15	13.5	17	33	69
GN.19394	GN 415-ZD-39-B1-KG-2	6.5	39	14.5	1	12	6	35	8.2	10	4.7	13.75	22	27	6.5	15	13.5	27	75	69
GN.19395	GN 415-ZD-39-B1-NG-1	6.5	39	14.5	1	12	6	35	8.2	10	4.7	13.75	22	27	6.5	15	13.5	17	33	93
GN.19396	GN 415-ZD-39-B1-NG-2	6.5	39	14.5	1	12	6	35	8.2	10	4.7	13.75	22	27	6.5	15	13.5	27	75	93
GN.19397	GN 415-ZD-39-B1-NR-1	6.5	39	14.5	1	12	6	35	8.2	10	4.7	13.75	22	27	6.5	15	13.5	17	33	94
GN.19398	GN 415-ZD-39-B1-NR-2	6.5	39	14.5	1	12	6	35	8.2	10	4.7	13.75	22	27	6.5	15	13.5	27	75	94

**INOX** STAINLESS STEEL

GN 415-B2

Code	Description	d	b1	b2	h1 +0.5	h2	k	l1	l2	l3	l4	r	s	m1	m2	m3	m4	[N]*	[N]#	△
GN.19219	GN 415-ZD-22-B2-KG-1	3.3	22	7	1	6	4	16.5	2.8	4.8	2.4	6.25	10	14	4	8	4.5	8	11	12
GN.19220	GN 415-ZD-22-B2-KG-2	3.3	22	7	1	6	4	16.5	2.8	4.8	2.4	6.25	10	14	4	8	4.5	11	20	12
GN.19221	GN 415-ZD-22-B2-NG-1	3.3	22	7	1	6	4	16.5	2.8	4.8	2.4	6.25	10	14	4	8	4.5	8	11	13
GN.19222	GN 415-ZD-22-B2-NG-2	3.3	22	7	1	6	4	16.5	2.8	4.8	2.4	6.25	10	14	4	8	4.5	11	20	13
GN.19223	GN 415-ZD-22-B2-NR-1	3.3	22	7	1	6	4	16.5	2.8	4.8	2.4	6.25	10	14	4	8	4.5	8	11	14
GN.19224	GN 415-ZD-22-B2-NR-2	3.3	22	7	1	6	4	16.5	2.8	4.8	2.4	6.25	10	14	4	8	4.5	11	20	14
GN.19299	GN 415-ZD-32-B2-KG-1	5.4	32	10	1	9	5	27.5	5	7	3.1	10	16	21	5.5	12	10	8	19	32
GN.19300	GN 415-ZD-32-B2-KG-2	5.4	32	10	1	9	5	27.5	5	7	3.1	10	16	21	5.5	12	10	19	45	32
GN.19301	GN 415-ZD-32-B2-NG-1	5.4	32	10	1	9	5	27.5	5	7	3.1	10	16	21	5.5	12	10	8	19	39
GN.19302	GN 415-ZD-32-B2-NG-2	5.4	32	10	1	9	5	27.5	5	7	3.1	10	16	21	5.5	12	10	19	45	39
GN.19303	GN 415-ZD-32-B2-NR-1	5.4	32	10	1	9	5	27.5	5	7	3.1	10	16	21	5.5	12	10	8	19	40
GN.19304	GN 415-ZD-32-B2-NR-2	5.4	32	10	1	9	5	27.5	5	7	3.1	10	16	21	5.5	12	10	19	45	40
GN.19399	GN 415-ZD-39-B2-KG-1	6.5	39	14.5	1	12	6	35	8.2	10	4.7	13.75	22	27	6.5	15	13.5	17	33	69
GN.19400	GN 415-ZD-39-B2-KG-2	6.5	39	14.5	1	12	6	35	8.2	10	4.7	13.75	22	27	6.5	15	13.5	27	75	69
GN.19401	GN 415-ZD-39-B2-NG-1	6.5	39	14.5	1	12	6	35	8.2	10	4.7	13.75	22	27	6.5	15	13.5	17	33	93
GN.19402	GN 415-ZD-39-B2-NG-2	6.5	39	14.5	1	12	6	35	8.2	10	4.7	13.75	22	27	6.5	15	13.5	27	75	93
GN.19403	GN 415-ZD-39-B2-NR-1	6.5	39	14.5	1	12	6	35	8.2	10	4.7	13.75	22	27	6.5	15	13.5	17	33	94
GN.19404	GN 415-ZD-39-B2-NR-2	6.5	39	14.5	1	12	6	35	8.2	10	4.7	13.75	22	27	6.5	15	13.5	27	75	94

\* Spring preload  
# Spring maximum load

Indexing and positioning elements

## GN 415-B3

INOX STAINLESS STEEL

Code	Description	d	b1	b2	h1 +0.5	h2	k	l1	l2	l3	l4	r	s	m1	m2	m3	m4	[N]*	[N]#	△
GN.19225	GN 415-ZD-22-B3-KG-1	3.3	22	7	1	6	4	16.5	2.8	4.8	2.4	6.25	10	14	4	8	4.5	8	11	12
GN.19226	GN 415-ZD-22-B3-KG-2	3.3	22	7	1	6	4	16.5	2.8	4.8	2.4	6.25	10	14	4	8	4.5	11	20	12
GN.19227	GN 415-ZD-22-B3-NG-1	3.3	22	7	1	6	4	16.5	2.8	4.8	2.4	6.25	10	14	4	8	4.5	8	11	13
GN.19228	GN 415-ZD-22-B3-NG-2	3.3	22	7	1	6	4	16.5	2.8	4.8	2.4	6.25	10	14	4	8	4.5	11	20	13
GN.19229	GN 415-ZD-22-B3-NR-1	3.3	22	7	1	6	4	16.5	2.8	4.8	2.4	6.25	10	14	4	8	4.5	8	11	14
GN.19230	GN 415-ZD-22-B3-NR-2	3.3	22	7	1	6	4	16.5	2.8	4.8	2.4	6.25	10	14	4	8	4.5	11	20	14
GN.19305	GN 415-ZD-32-B3-KG-1	5.4	32	10	1	9	5	27.5	5	7	3.1	10	16	21	5.5	12	10	8	19	32
GN.19306	GN 415-ZD-32-B3-KG-2	5.4	32	10	1	9	5	27.5	5	7	3.1	10	16	21	5.5	12	10	19	45	32
GN.19307	GN 415-ZD-32-B3-NG-1	5.4	32	10	1	9	5	27.5	5	7	3.1	10	16	21	5.5	12	10	8	19	39
GN.19308	GN 415-ZD-32-B3-NG-2	5.4	32	10	1	9	5	27.5	5	7	3.1	10	16	21	5.5	12	10	19	45	39
GN.19309	GN 415-ZD-32-B3-NR-1	5.4	32	10	1	9	5	27.5	5	7	3.1	10	16	21	5.5	12	10	8	19	40
GN.19310	GN 415-ZD-32-B3-NR-2	5.4	32	10	1	9	5	27.5	5	7	3.1	10	16	21	5.5	12	10	19	45	40
GN.19405	GN 415-ZD-39-B3-KG-1	6.5	39	14.5	1	12	6	35	8.2	10	4.7	13.75	22	27	6.5	15	13.5	17	33	69
GN.19406	GN 415-ZD-39-B3-KG-2	6.5	39	14.5	1	12	6	35	8.2	10	4.7	13.75	22	27	6.5	15	13.5	27	75	69
GN.19407	GN 415-ZD-39-B3-NG-1	6.5	39	14.5	1	12	6	35	8.2	10	4.7	13.75	22	27	6.5	15	13.5	17	33	93
GN.19408	GN 415-ZD-39-B3-NG-2	6.5	39	14.5	1	12	6	35	8.2	10	4.7	13.75	22	27	6.5	15	13.5	27	75	93
GN.19409	GN 415-ZD-39-B3-NR-1	6.5	39	14.5	1	12	6	35	8.2	10	4.7	13.75	22	27	6.5	15	13.5	17	33	94
GN.19410	GN 415-ZD-39-B3-NR-2	6.5	39	14.5	1	12	6	35	8.2	10	4.7	13.75	22	27	6.5	15	13.5	27	75	94

## GN 415-B4

INOX STAINLESS STEEL

Code	Description	d	b1	b2	h1 +0.5	h2	k	l1	l2	l3	l4	r	s	m1	m2	m3	m4	[N]*	[N]#	△
GN.19231	GN 415-ZD-22-B4-KG-1	3.3	22	7	1	6	4	16.5	2.8	4.8	2.4	6.25	10	14	4	8	4.5	8	11	12
GN.19232	GN 415-ZD-22-B4-KG-2	3.3	22	7	1	6	4	16.5	2.8	4.8	2.4	6.25	10	14	4	8	4.5	11	20	12
GN.19233	GN 415-ZD-22-B4-NG-1	3.3	22	7	1	6	4	16.5	2.8	4.8	2.4	6.25	10	14	4	8	4.5	8	11	13
GN.19234	GN 415-ZD-22-B4-NG-2	3.3	22	7	1	6	4	16.5	2.8	4.8	2.4	6.25	10	14	4	8	4.5	11	20	13
GN.19235	GN 415-ZD-22-B4-NR-1	3.3	22	7	1	6	4	16.5	2.8	4.8	2.4	6.25	10	14	4	8	4.5	8	11	14
GN.19236	GN 415-ZD-22-B4-NR-2	3.3	22	7	1	6	4	16.5	2.8	4.8	2.4	6.25	10	14	4	8	4.5	11	20	14
GN.19311	GN 415-ZD-32-B4-KG-1	5.4	32	10	1	9	5	27.5	5	7	3.1	10	16	21	5.5	12	10	8	19	32
GN.19312	GN 415-ZD-32-B4-KG-2	5.4	32	10	1	9	5	27.5	5	7	3.1	10	16	21	5.5	12	10	19	45	32
GN.19313	GN 415-ZD-32-B4-NG-1	5.4	32	10	1	9	5	27.5	5	7	3.1	10	16	21	5.5	12	10	8	19	39
GN.19314	GN 415-ZD-32-B4-NG-2	5.4	32	10	1	9	5	27.5	5	7	3.1	10	16	21	5.5	12	10	19	45	39
GN.19315	GN 415-ZD-32-B4-NR-1	5.4	32	10	1	9	5	27.5	5	7	3.1	10	16	21	5.5	12	10	8	19	40
GN.19316	GN 415-ZD-32-B4-NR-2	5.4	32	10	1	9	5	27.5	5	7	3.1	10	16	21	5.5	12	10	19	45	40
GN.19411	GN 415-ZD-39-B4-KG-1	6.5	39	14.5	1	12	6	35	8.2	10	4.7	13.75	22	27	6.5	15	13.5	17	33	69
GN.19412	GN 415-ZD-39-B4-KG-2	6.5	39	14.5	1	12	6	35	8.2	10	4.7	13.75	22	27	6.5	15	13.5	27	75	69
GN.19413	GN 415-ZD-39-B4-NG-1	6.5	39	14.5	1	12	6	35	8.2	10	4.7	13.75	22	27	6.5	15	13.5	17	33	93
GN.19414	GN 415-ZD-39-B4-NG-2	6.5	39	14.5	1	12	6	35	8.2	10	4.7	13.75	22	27	6.5	15	13.5	27	75	93
GN.19415	GN 415-ZD-39-B4-NR-1	6.5	39	14.5	1	12	6	35	8.2	10	4.7	13.75	22	27	6.5	15	13.5	17	33	94
GN.19416	GN 415-ZD-39-B4-NR-2	6.5	39	14.5	1	12	6	35	8.2	10	4.7	13.75	22	27	6.5	15	13.5	27	75	94

\* Spring preload

# Spring maximum load